

Live Sawn Red/White Oak

Allowed

- Sound Tight Knots
- Fillable Knots up to size of a Quarter
- Open Checking
- Worm Holes
- Bark Pockets

Not Allowed

- Shake
- Rot
- Open Knots larger than a quarter
- Skip on face
- Splits longer than 1/2 of board width (8" wide allows for 4" split)
- Sticker stain

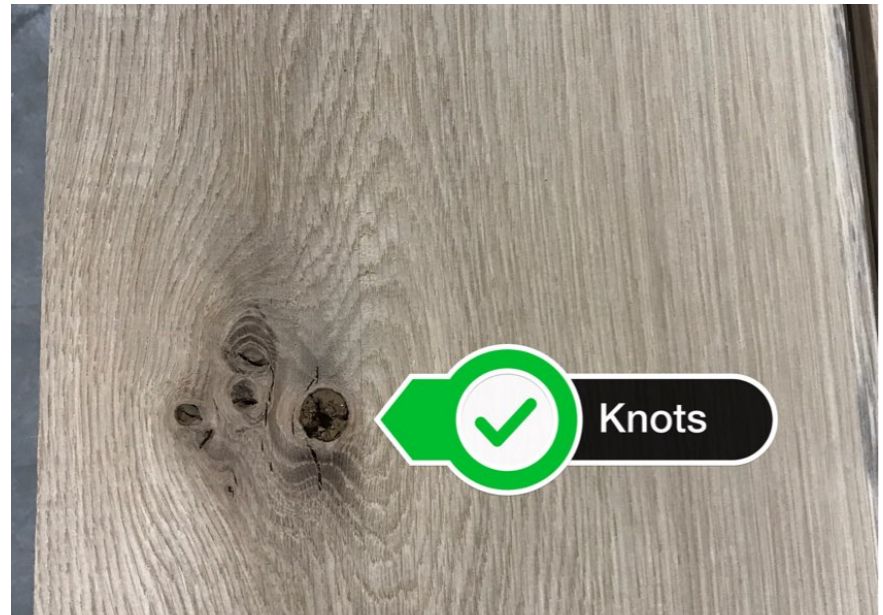

Live Sawn Red/White Oak

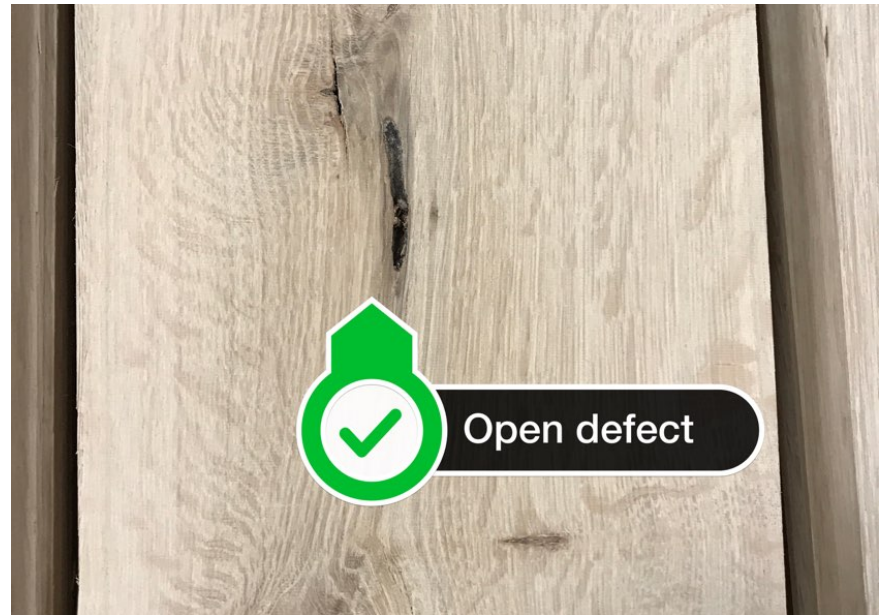
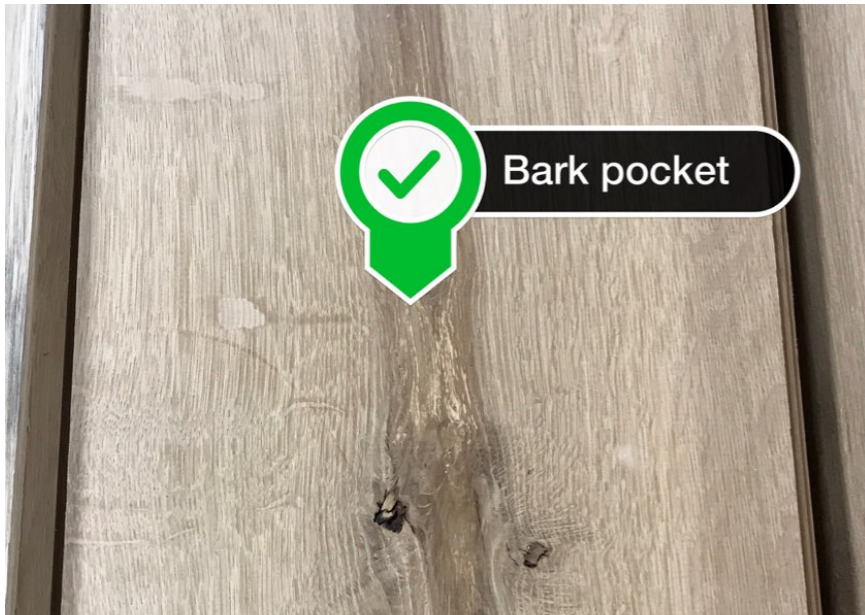
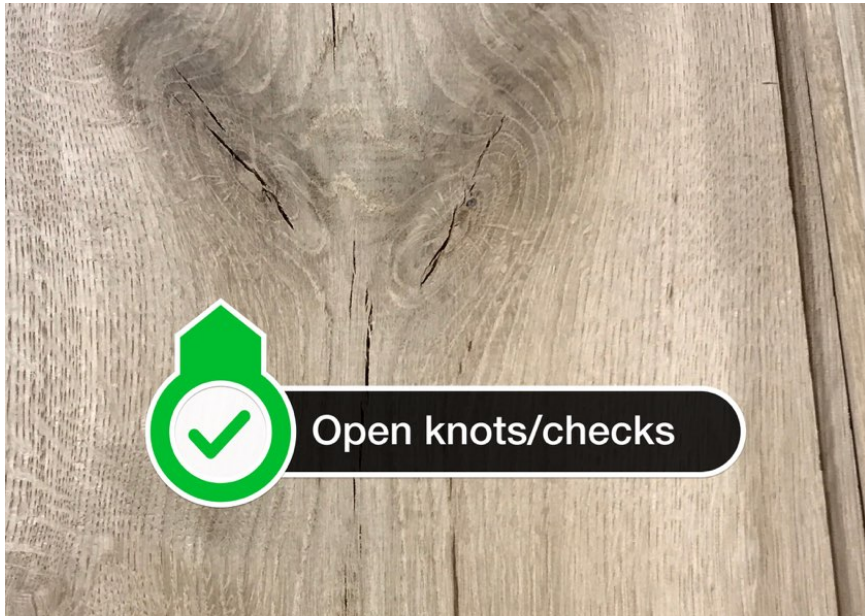

Above pictures reflect overall character of Live Sawn Grade and are included if not specified.

Live Sawn Red/White Oak

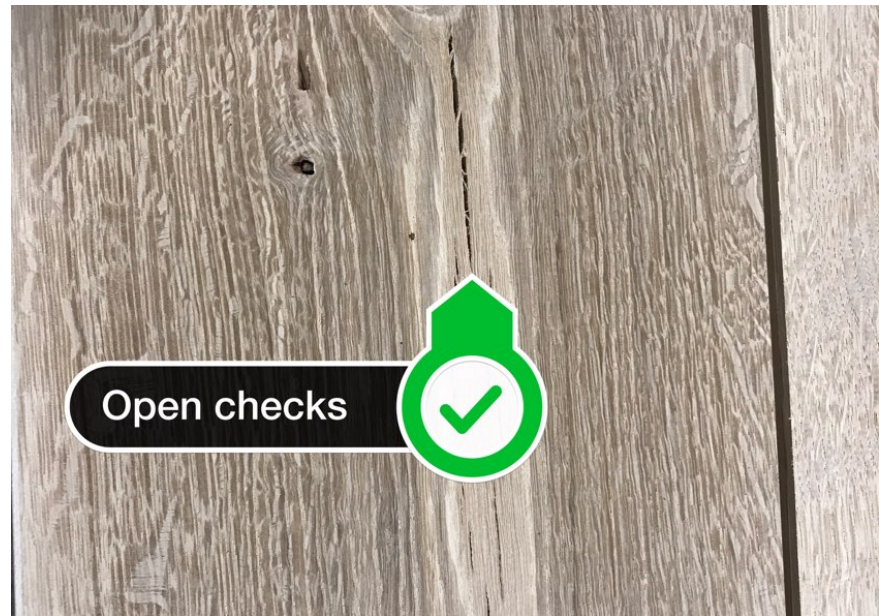
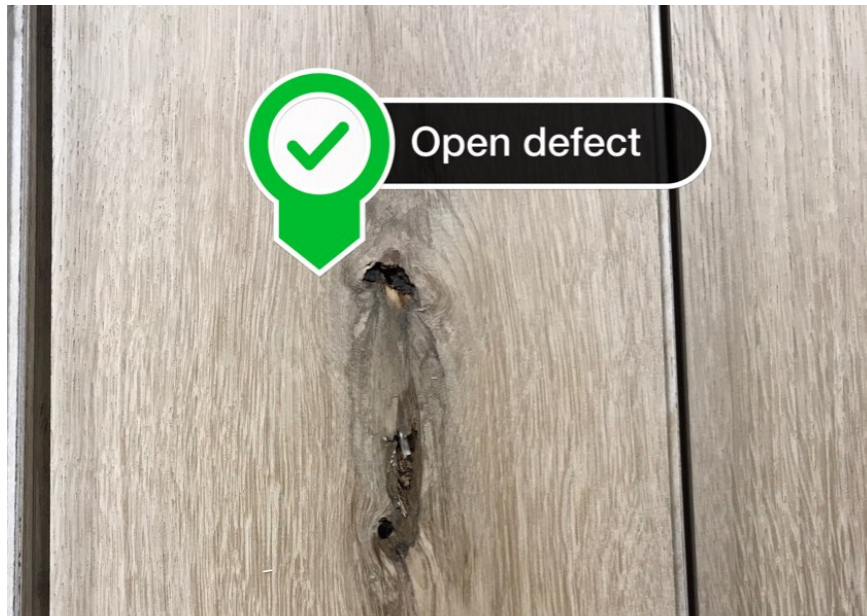
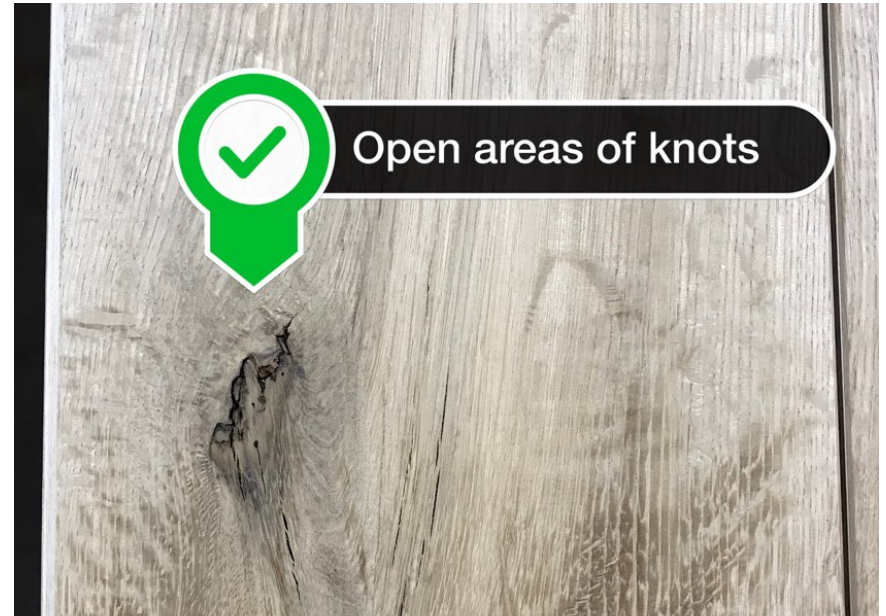
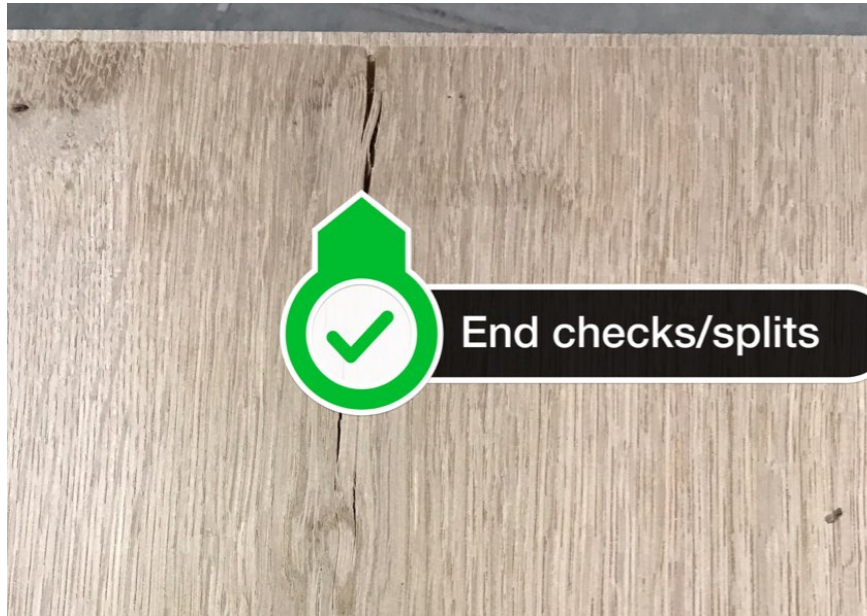

Above pictures reflect overall character of Live Sawn Grade and are included if not specified.

Live Sawn Red/White Oak

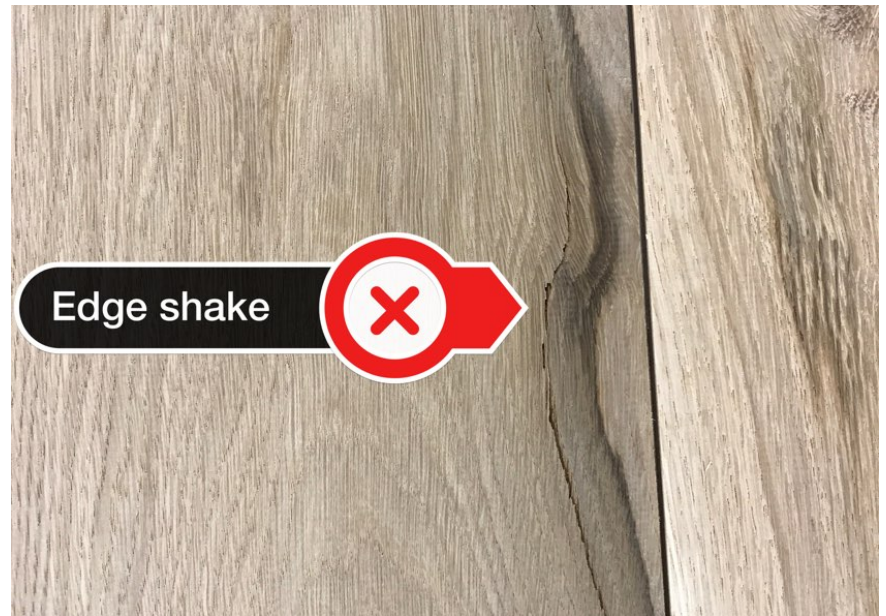

Above pictures reflect overall character of Live Sawn Grade and are included if not specified.